

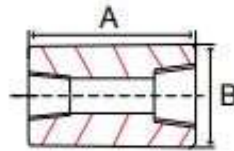

Forged Reducing Couplings

304 Stainless Steel, Class 3000

Inches / Pounds



Part #	NPT Thread Sizes (inch)	Length (A)	Width (B)	Approx Weight (in Lbs.)
K3RC.25X.125S	1/4 x 1/8	1.38	0.75	0.10
K3RC.375X.125S	3/8 x 1/8	1.50	0.88	0.10
K3RC.375X.25S	3/8 x 1/4	1.50	0.88	0.10
K3RC.5X.125S	1/2 x 1/8	1.88	1.12	0.20
K3RC.5X.25S	1/2 x 1/4	1.88	1.12	0.40
K3RC.5X.375S	1/2 x 3/8	1.88	1.12	0.20
K3RC.75X.25S	3/4 x 1/4	2.00	1.33	0.40
K3RC.75X.375S	3/4 x 3/8	2.00	1.33	0.40
K3RC.75X.5S	3/4 x 1/2	2.00	1.33	0.40
K3RC1X.25S	1 x 1/4	2.38	1.75	0.80
K3RC1X.375S	1 x 3/8	2.38	1.75	0.80
K3RC1X.5S	1 x 1/2	2.38	1.75	0.80
K3RC1X.75S	1 x 3/4	2.38	1.75	0.80
K3RC1.25X.5S	1-1/4 x 1/2	2.62	2.25	1.50
K3RC1.25X.75S	1-1/4 x 3/4	2.62	2.25	1.50
K3RC1.25X1S	1-1/4 x 1	2.62	2.25	1.50
K3RC1.5X.25S	1-1/2 x 1/4	3.12	2.50	2.10
K3RC1.5X.375S	1-1/2 x 3/8	3.12	2.50	2.10
K3RC1.5X.5S	1-1/2 x 1/2	3.12	2.50	2.10
K3RC1.5X.75S	1-1/2 x 3/4	3.12	2.50	2.10
K3RC1.5X1S	1-1/2 x 1	3.12	2.50	2.80
K3RC1.5X1.25S	1-1/2 x 1-1/4	3.12	2.50	2.10
K3RC2X.5S	2 x 1/2	3.38	3.00	3.00
K3RC2X.75S	2 x 3/4	3.38	3.00	3.00
K3RC2X1S	2 x 1	3.38	3.00	4.50
K3RC2X1.25S	2 x 1-1/4	3.38	3.00	3.30
K3RC2X1.5S	2 x 1 1/2	3.38	3.00	3.90

* Forged 304 Stainless Steel material conforms to ASTM A182 grade F304/304L

* Threading per ASME B1.20.1

* Dimensions conform to ASME B16.11